

Appartement A-12

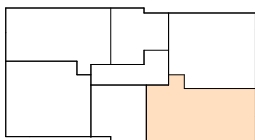
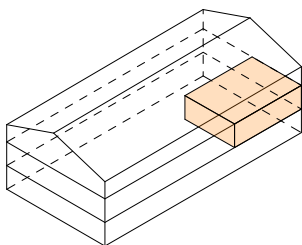

Pièces	3.5
Situation	étage 1
Surface PPE *	75.14 m²
Surface balayable	70.16 m²
Balcon	8.83 m², 1 x est
Orientation	sud - est
Sous-sol	5.63 m², 1 cave
Intérieur	1 place de parc

* 50% Balcon + 10% Cave + Appartement